

ABANAKI CHIPERATOR™

Installation Instructions

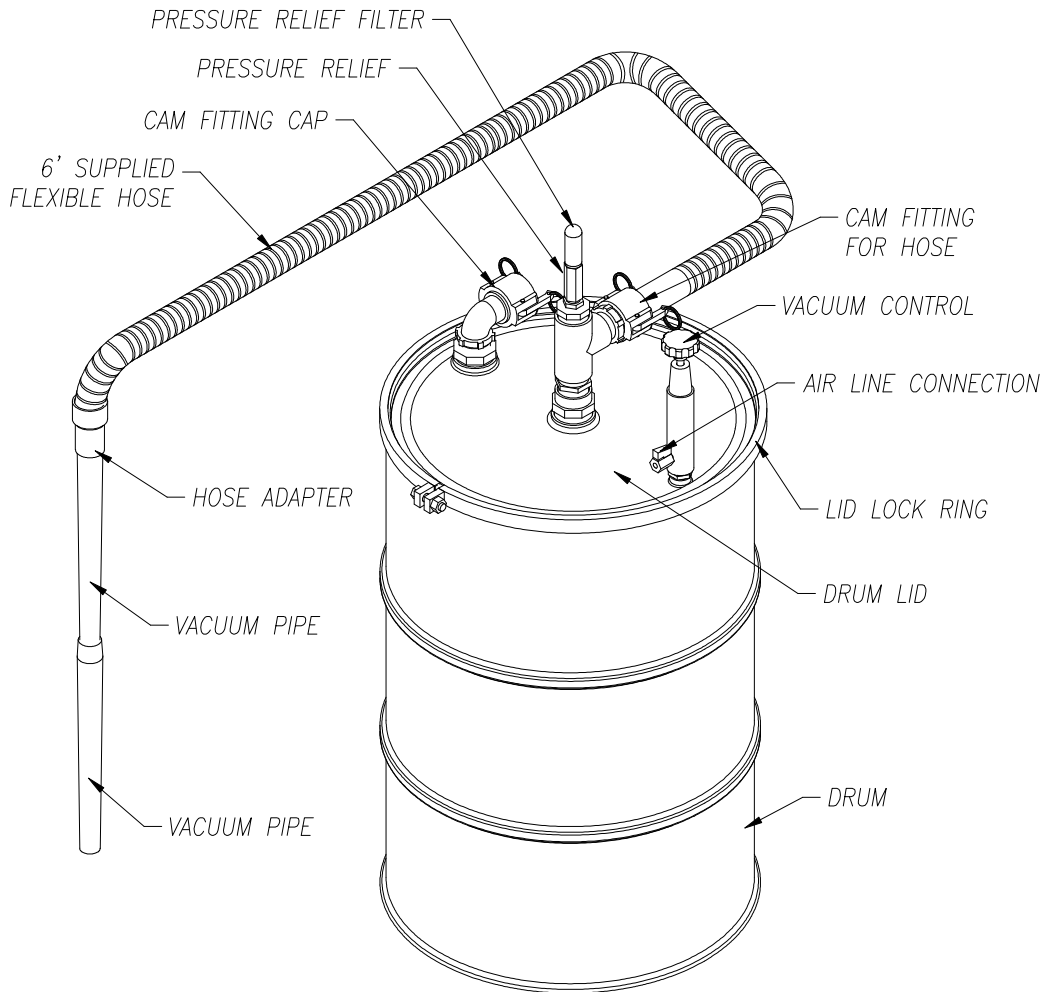

Read entire instructions, including Warnings/Recommendations, prior to use.

Your Abanaki Chiperator has been manufactured and packaged to rigorous standards of design and service. Proper installation and maintenance of the unit is essential for efficient and long lasting use. We have tried to make these instructions as clear as possible. If you have any questions, please call: 1-800-358-7546

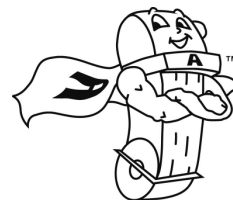

ABANAKI
CORPORATION

17387 Munn Road
Chagrin Falls, OH 44023
Phone: (440) 543-7400
Fax: (440) 543-7404

1-800-358-SKIM (7546)
www.abanaki.com



ABANAKI
CORPORATION
17387 Munn Road
Chagrin Falls, OH 44023
Phone: (440) 543-7400
Fax: (440) 543-7404
1-800-358-SKIM (7546)
www.abanaki.com

Chiperator™ Installation Instructions

IMPORTANT: Read entire set of instructions, including Warnings/Recommendations, PRIOR to use.

Step 1. Remove all three plugs from fittings on drum lid.

Step 2. Using the proper thread sealant, install the Vacuum Control, 8-1/2" Fill Tube, and the 33" Empty Tube into the three fittings on drum lid. (Note: The 8-1/2" Fill Tube MUST be placed in the center fitting on lid.) (See Fig. 1)

Step 3. Place the Filter inside the Filter Basket, and set the filter basket into the middle of the drum. (See Fig. 2)

Step 4. Carefully place the drum lid on top of the drum, making sure the 8-1/2" Fill Tube goes into the middle of the filter bag and filter basket. Fasten with Lid Lock Ring. **NOTE:** Be certain Lid Lock Ring is seated evenly and tight on drum.

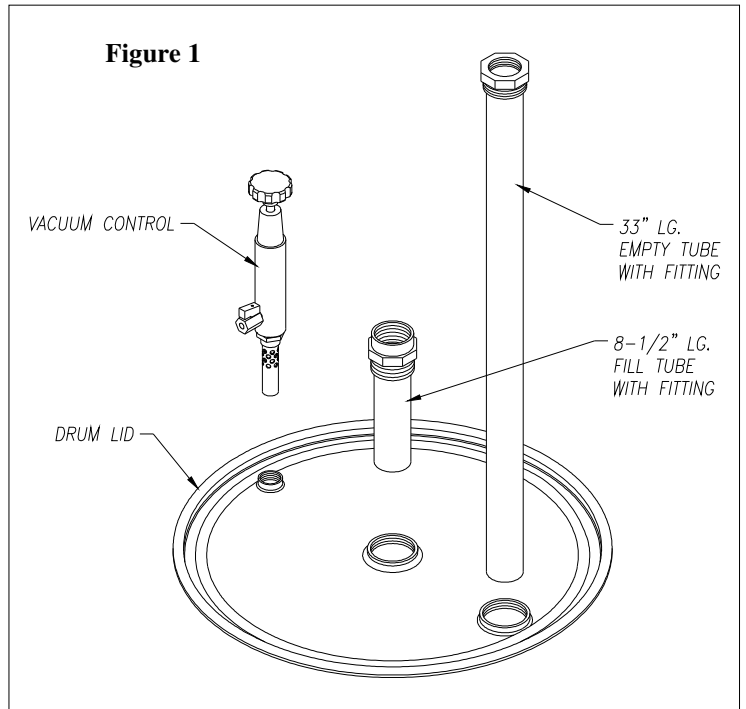

Step 5. Using the proper thread sealant, assemble Pressure Relief valve into top of drum. Note: Make sure arrow on pressure relief is pointing UP. (See Fig. 3)

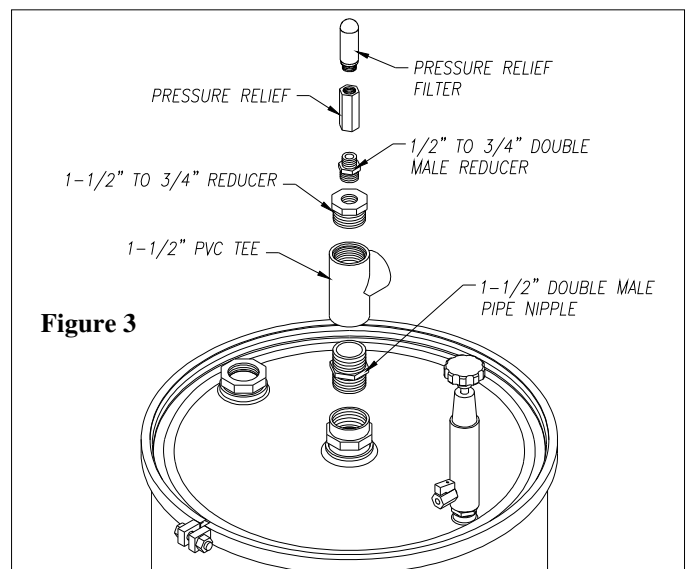
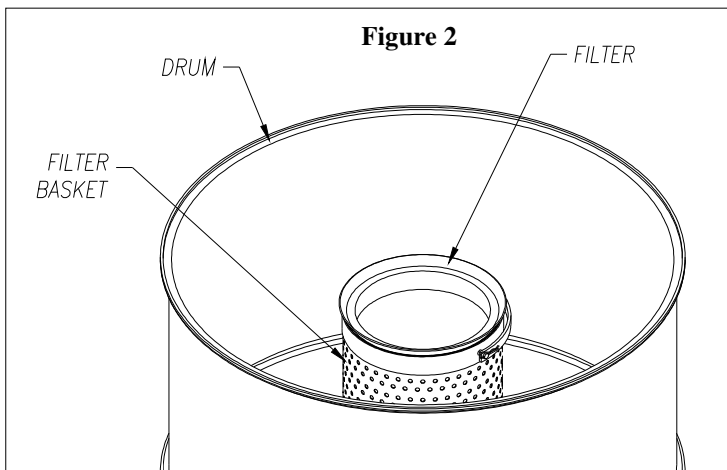



ABANAKI
CORPORATION
17387 Munn Road
Chagrin Falls, OH 44023
Phone: (440) 543-7400
Fax: (440) 543-7404
1-800-358-SKIM (7546)
www.abanaki.com

Chiperator™ Installation Instructions

Step 6. Using the proper thread sealant, thread the Cam & Groove Elbow Fitting into the 33" Empty Tube Fitting, and the Cam & Groove Straight Fitting into the center Tee. (See Fig. 4)

Step 7. **Filling the Drum:**

Place the Cam & Groove Hose Fitting on the center straight cam and the Cam & Groove Cap on the outside elbow. (See Fig. 5)

Draining the Drum:

Place the Cam & Groove Cap on the center straight cam and the Cam & Groove Hose Fitting on the outside elbow. (See Fig. 5)

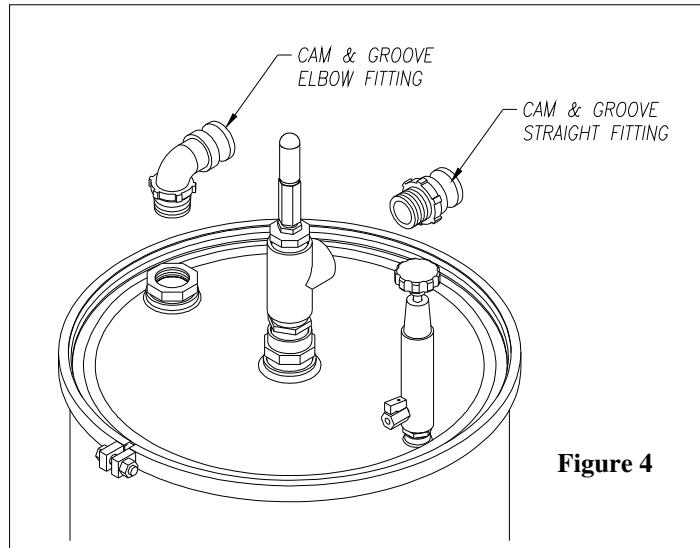

Figure 4

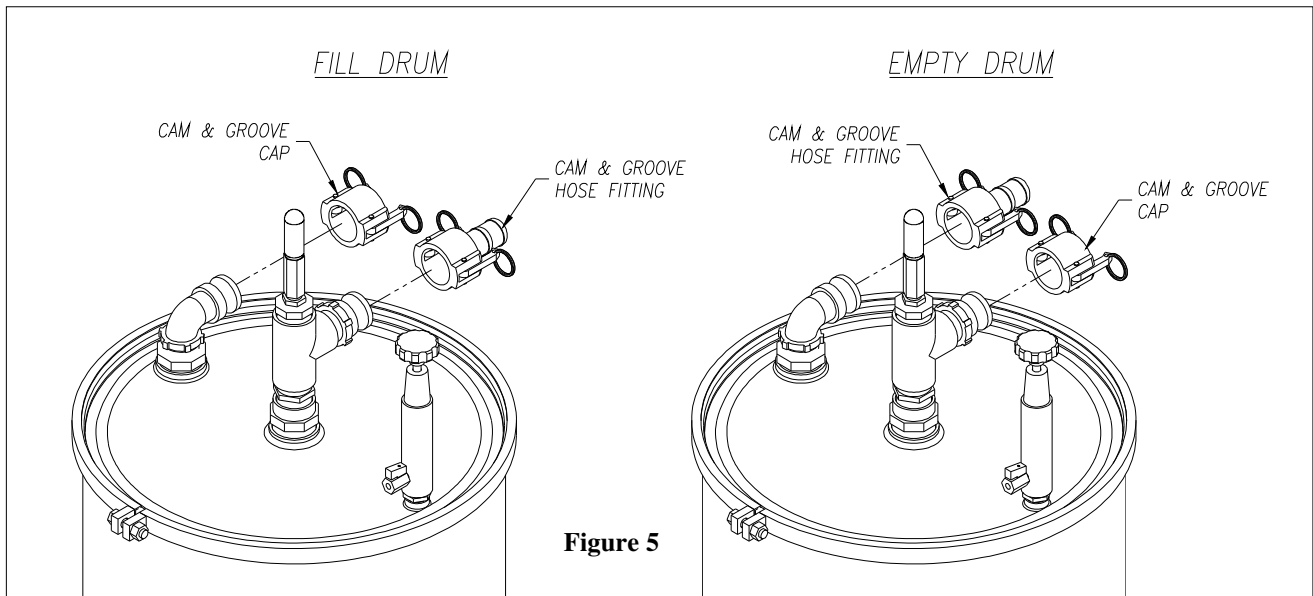

Figure 5

Step 8. Turn the air line valve on the side of the vacuum control to the vertical (closed) position. Attach a minimum 1/2" air line to air line fitting on vacuum control. Maximum air line pressure of 140psi.



ABANAKI
CORPORATION
17387 Munn Road
Chagrin Falls, OH 44023
Phone: (440) 543-7400
Fax: (440) 543-7404
1-800-358-SKIM (7546)
www.abanaki.com

Chiperator™ Installation Instructions

Filling the Drum:

With the Cam & Groove fittings on the appropriate straight and elbow fitting as shown in step 7, connect one end of the supplied 6' flexible hose to the Cam & Groove Hose Fitting. Assemble the two Vacuum Pipe Extensions with the Hose Adapter. (See Fig. 6) Place the Hose Adapter onto the top vacuum pipe extension and put the other end of the 6' flexible hose into the hose adapter.

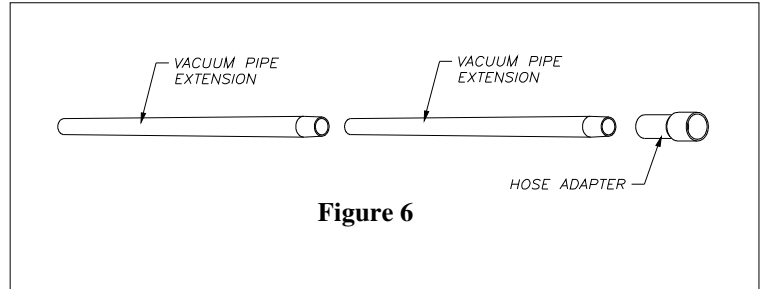

Figure 6

With customer air line connected, and valve on vacuum control closed, turn the black knob on the top of the vacuum control counter-clockwise. (**Fill Drum** printed on top of knob)
When you are ready to start filling, open the air line valve. When the drum is full, the automatic shutoff in the vacuum control will shut the system off.
Turn the air valve back to the closed position.

IMPORTANT:

Air line **MUST** be in OFF position prior to removing Cam & Groove Fittings or Drum Lid.

Draining the Drum:

Switch the Cam & Groove fittings onto the appropriate straight and elbow fitting as shown in step 7. With the 6' flexible hose still connected to the Cam & Groove Hose Fitting, place the opposite end of the hose back into the coolant sump or into a suitable collection container.

With customer air line connected, and valve on vacuum control closed, turn the black knob on the top of the vacuum control clockwise. (**Empty Drum** printed on top of knob)
When you are ready to start draining, open air line valve.
Turn air valve back to closed position when finished.

Note: While in draining mode, watch when coolant begins to show signs of contamination. Shutdown system and check filter, replacing with new filter if necessary.

*** Warnings/Recommendations: ***

- Use only with non-corrosive liquids
- Drum and lid should be replaced every 12 months, or replace with Stainless Steel Drum and Lid
- Unit must be used with filter bag at all times
- Inspect filter bag weekly for integrity
- Filter bag should be cleaned & changed on a regular basis
- Check 55 gal. Drum and lid periodically for integrity and corrosion
- Only Abanaki – Tested 55 gal. Drum & Lid should be used with unit
- When installing cover, be certain lock-ring is seated evenly and tight on drum

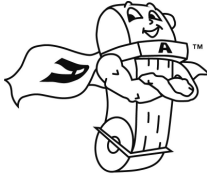

ABANAKI
CORPORATION

17387 Munn Road
Chagrin Falls, OH 44023
Phone: (440) 543-7400
Fax: (440) 543-7404
1-800-358-SKIM (7546)
www.abanaki.com

Chiperator Parts List

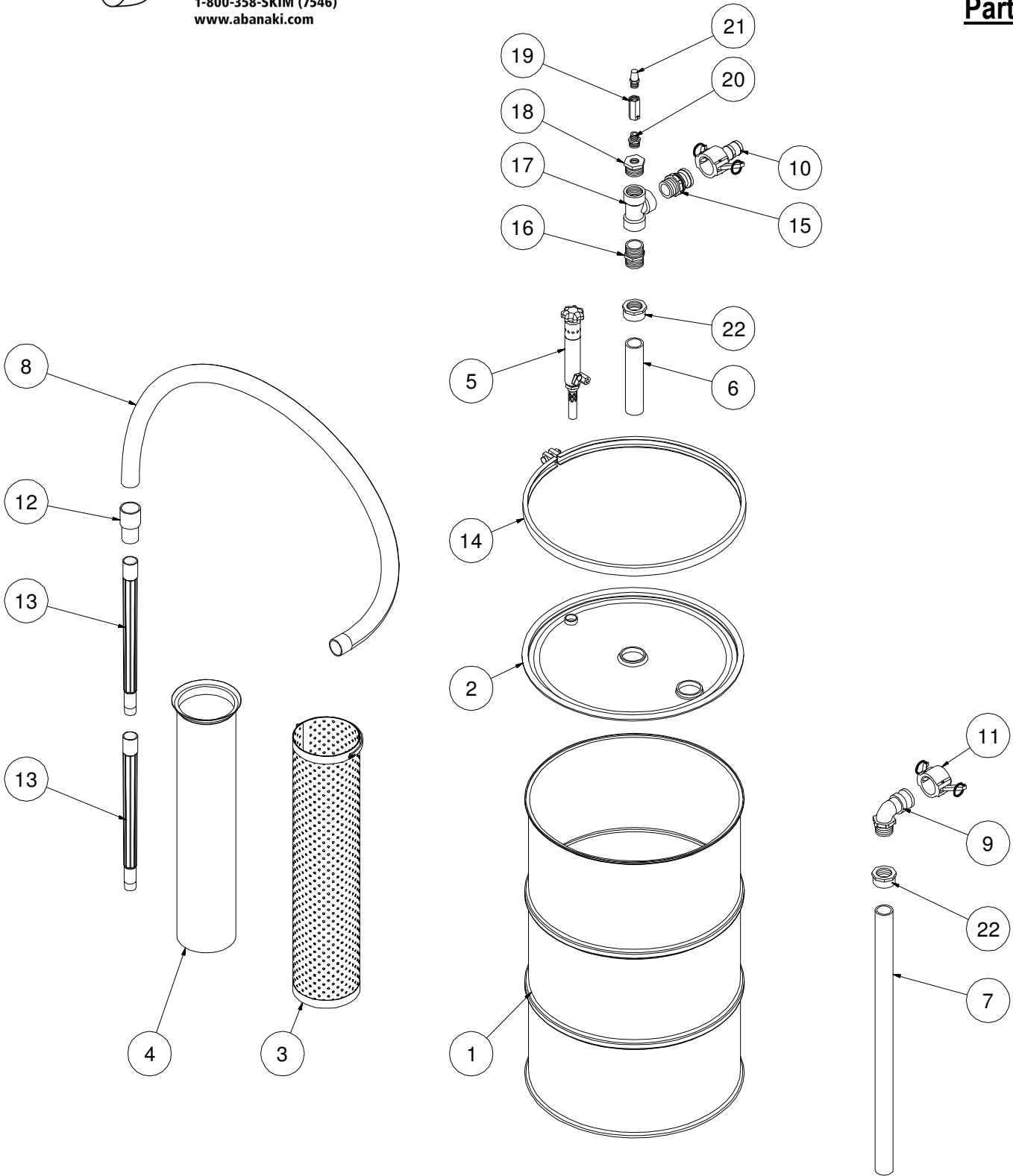

ITEM	QTY.	PART NAME	PART NUMBER	ITEM	QTY.	PART NAME	PART NUMBER
1	1	55 Gallon Drum	PCHIP-B3	12	1	Hose Adapter	PQV-H
2	1	Drum Lid	PCHIP-B1	13	2	Vacuum Pipe Extension	PCHIP-J
3	1	Filter Basket	PCHIP-C	14	1	Lid Lock Ring	PCHIP-B2
4	1	Filter Bag – 25 micron	PCHIP-A	15	1	Cam & Groove Straight Fitting	PCHIP-S
5	1	Vacuum Control	PCHIP-G	16	1	1-1/2" Pipe Male to Male Nipple	PCHIP-R
6	1	8-1/2" Lg. Empty Tube	PCHIP-X	17	1	1-1/2" PVC Tee	PCHIP-T
7	1	33" Lg. Fill Tube	PCHIP-X2	18	1	PVC 1-1/2" to 3/4" Reducer	PCHIP-O
8	1	6' Flexible Hose	PQV-X	19	1	Pressure Relief Valve	PCHIP-M1
9	1	Cam & Groove Elbow Fitting	PQV-C	20	1	3/4" to 1/2" Male to Male Reducer	PCHIP-P
10	1	Cam & Groove Hose Fitting	PQV-B	21	1	Pressure Relief Filter	PCHIP-M2
11	1	Cam & Groove Cap	PCHIP-F	22	2	1-1/1" Tube Fitting	PCHIP-L2

Copyright 2012 by ABANAKI CORPORATION. All rights reserved. No part of this work covered by copyright may be reproduced or used in any form or by any means without written permission of Abanaki Corporation. Abanaki reserves the right to make changes to the Chiperator parts list at any time, without notice. 10/12